



For Lease

Prime Retail in the Heart of Jamaica Center

160-08 Jamaica Avenue | Queens, NY 11432

COMPASS
COMMERCIAL

Prime Retail in the heart of Jamaica Center
160-08 Jamaica Avenue
Queens, NY 11432

For Lease

Size		Ceiling Height
------	--	----------------

Ground Floor	3,241 sf	14'
Cellar	2,836 sf	

Frontage	30'
----------	-----

Co-Tenants	Burlington, H&M, Target (opening March 2021), Jolibee (Coming Soon), Old Navy, Multiplex Cinemas, Wendy's, McDonald's, Snipes, Starbucks, Taco Bell, Chipotle, Panda Express, Burger King, Blink Fitness, City MD, Shoppers World, Rainbow, Walgreens.
------------	--

Transportation	Jamaica Center Parsons / Archer Station E J Z
----------------	--

Asking Rent	Upon Request
-------------	--------------

Highlights

- New Construction
- Prime retail on Jamaica Avenue
- Can be vented
- Huge signage under Burlingtons sign with a blade sign available
- Exceptional co-tenancy



Brett Weinblatt
Vice President
M: 646.665.4278
brett.weinblatt@compass.com

Ralph Hanan
Vice President
M: 908.433.6624
ralph.hanan@compass.com

Information provided has been obtained from sources we believe reliable. Landlord makes no representations as to the accuracy of these plans and recipients should not rely on their accuracy. Recipients to verify any and all accuracy of information. All sizes are approximate and are subject to change.

COMPASS
COMMERCIAL

Floor Plans

160-08 Jamaica Avenue, Queens, NY 11432

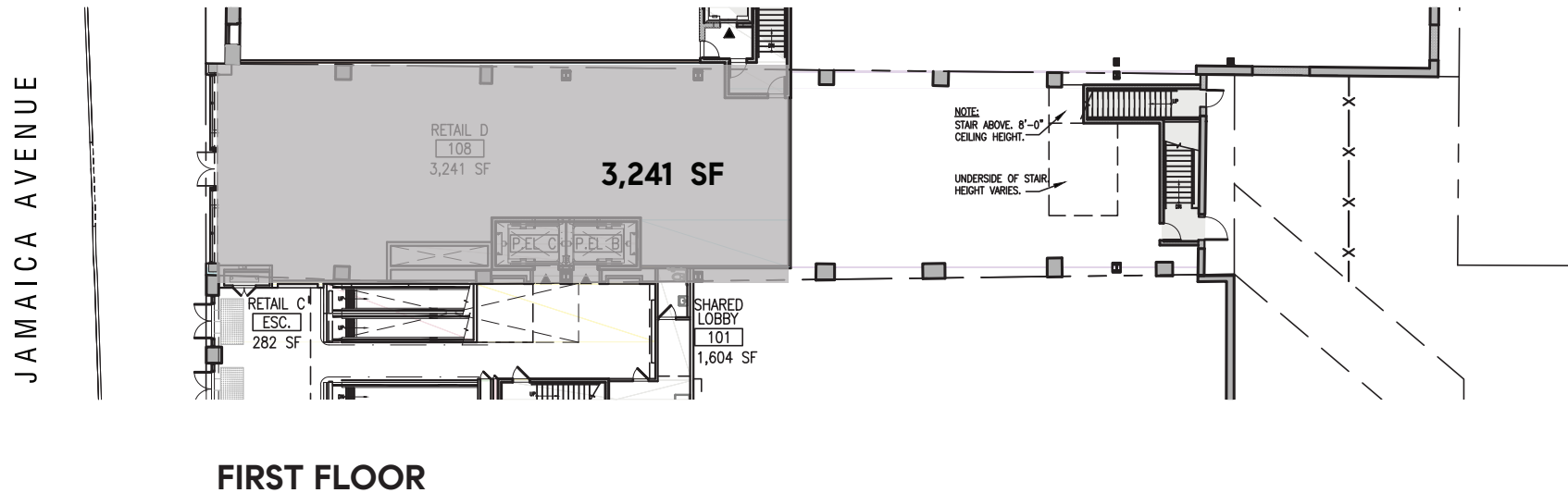
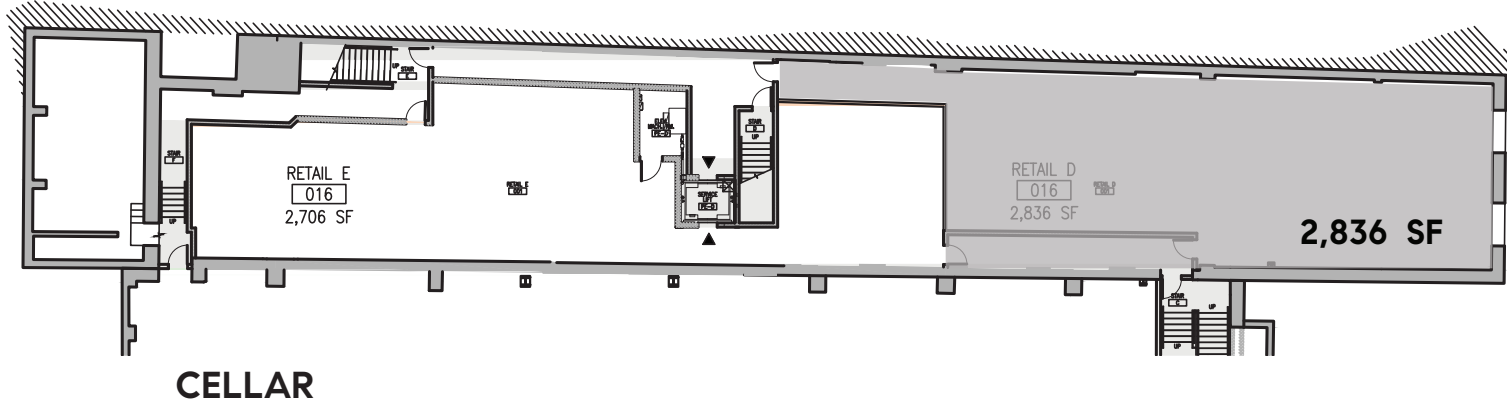

Neighborhood Guide

160-08 Jamaica Avenue, Queens, NY 11432

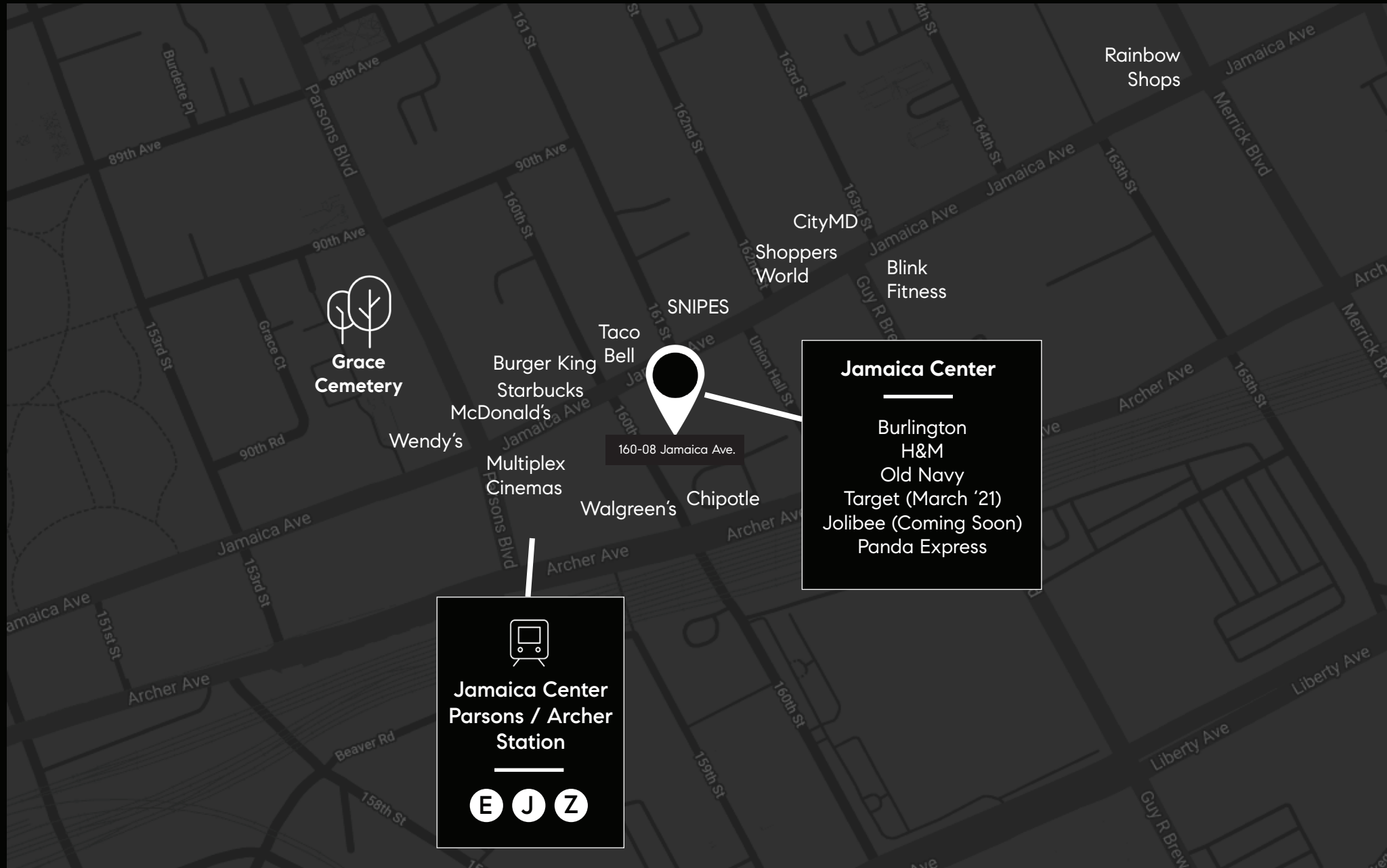



COMPASS
COMMERCIAL



Please contact us for more information



Brett Weinlatt
Vice President
M: 646.665.4278
brett.weinblatt@compass.com



Ralph Hanan
Vice President
M: 908.433.6624
ralph.hanan@compass.com

COMPASS
COMMERCIAL